

SURGICAL TECHNIQUE GUIDE

---

# LATERAL SPINE TRUSS SYSTEM

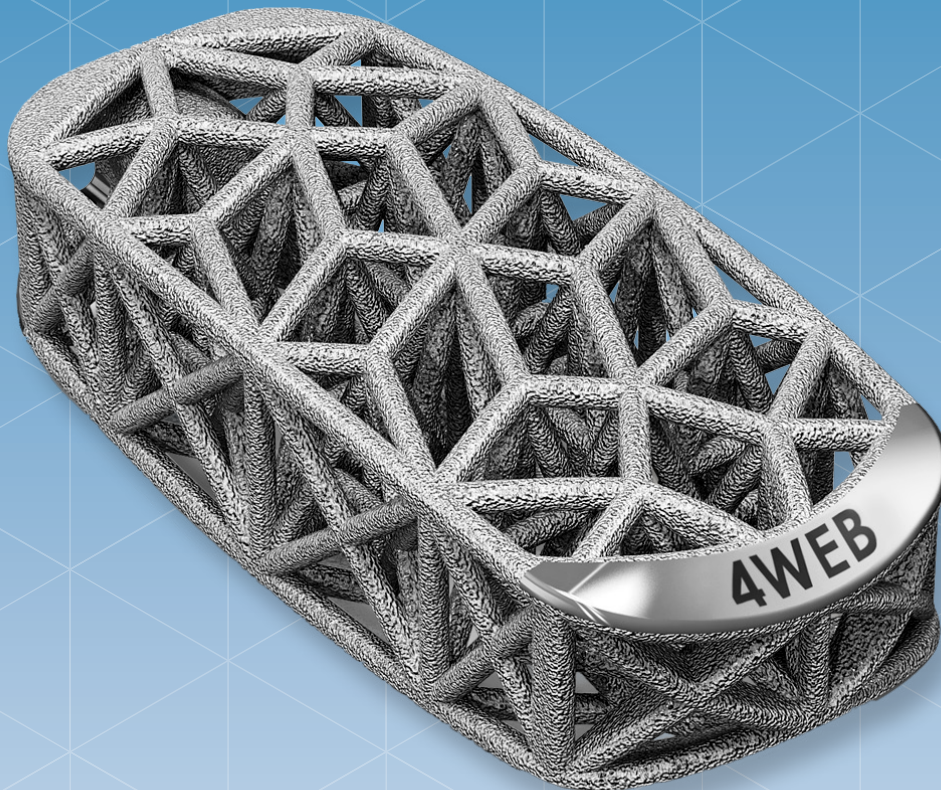

# TABLE OF CONTENTS

<b>TRUSS IMPLANT TECHNOLOGY™</b>	<b>3</b>
<b>IMPLANT OVERVIEW</b>	<b>4</b>
<b>SURGICAL PROCEDURE</b>	<b>5</b>

Proper surgical procedure and technique are the responsibility of the medical professional. The following guidelines are furnished for information purposes only. Each surgeon must evaluate the appropriateness of the procedure based on his or her medical training and experience. Prior to use of the system, the surgeon should refer to the product's Instructions For Use (IFU) for complete warnings, precautions, indications, contraindications and adverse effects. IFUs are available by contacting 4WEB MEDICAL, +1 (800) 285-7090.

# TRUSS IMPLANT TECHNOLOGY



Novel Truss Implant Technology™ provides a Snow Shoe Design that distributes load across the bone / implant interface minimizing point loading and reduces the risk of subsidence.



4WEB's hierarchical surface roughness spans from the macro to nano scale providing a scaffold for cell adhesion and differentiation. These surface features have shown gene expression of certain osteogenic markers.



Open architecture implant design allows for bone growth throughout the entire implant construct and enables greater graft packing volume.

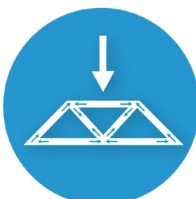

Optimized strain distribution through implant struts delivers a biomechanical stimulus for bone growth.



Truss Implant Technology™ limits imaging artifact.

## LSTS OVERVIEW

The Lateral Spine Truss System (LSTS) Interbody Fusion Device contains multiple footprints in a variety of heights and lordotic angles to accommodate the patient's anatomy. It is not intended to be used as a standalone device and must be used with supplemental fixation. The LSTS Interbody Fusion Device implants are provided sterile. Sizers and instruments are provided non-sterile and require sterilization prior to use.

# SURGICAL PROCEDURE

## PRE-OPERATIVE PLANNING

- ▲ Pre-operative planning with radiographs and other advanced imaging modalities can be helpful in estimating the appropriately sized implants with the goal of restoring disc height and fractional lordosis.

Determine the surgical approach based on the surgeon's preference. Implants and sizers are equipped with straight and offset instrument orientations.

## PATIENT POSITIONING

- ▲ Place the patient in a lateral decubitus position on the operating table with the lumbar spine in neutral to slight extension.
- ▲ Fluoroscopy can be utilized to aid with patient positioning.
- ▲ Using fluoroscopy, verify the location of the iliac crest and lower ribs in relation to the disc space of interest.

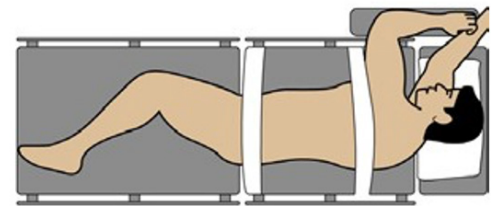

Figure 1

NOTE: At times you may want to break the table in order to gain better access to the operative level(s). Although infrequent, a few patients may have a deep-seated L4 – L5 disc space that could be difficult to reach via a direct lateral approach, even if table-breaking options are employed. If anatomical restrictions are present that prevent direct access to the disc space an alternative surgical approach should be considered.

## ACCESS AND EXPOSURE

- ▲ Locate the correct operative level under fluoroscopic guidance. Confirm the target segment and mark the initial incision site. Make a skin incision targeting the anterior third of the disc space. Separate the abdominal oblique muscles with blunt dissection and enter the retroperitoneal space. Move the peritoneum anterior with forefinger and continue blunt dissection to palpate down to the psoas muscle.
- ▲ Once the operative level(s) have been exposed, confirm the centerline of the affected level(s) with fluoroscopic imaging.

NOTE: Any bone removed during access and exposure may be used for autologous graft packing.

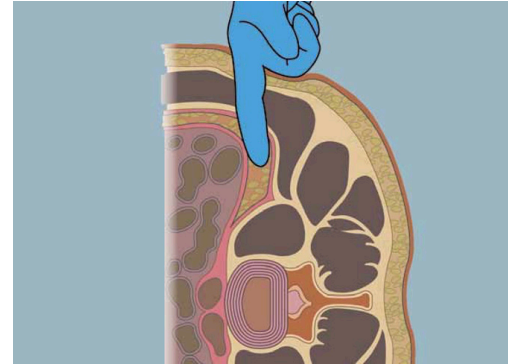

Figure 2

## TISSUE DILATION AND RETRACTION

- ▲ Use the surgeon's preferred dilator and retraction system to gain access to the disc space. Perform tissue dilation and retraction according to the instrument manufacturer's instructions for use.

## DISCECTOMY AND ENDPLATE PREPARATION

- ▲ Perform an annulotomy and subsequent lateral lumbar discectomy within the constraints of the operative window.
- ▲ Remove the superficial layers of the cartilaginous endplates down to bleeding bone while trying to avoid compromising the integrity of the bony endplates.
- ▲ Additional distraction may be applied as desired to increase visualization.

NOTE: Appropriate cleaning of the endplates is important to provide blood flow to the graft packed inside the implant. Excessive cleaning, on the other hand, can weaken the endplates. Take care to ensure that no damage is caused to the nerve roots.

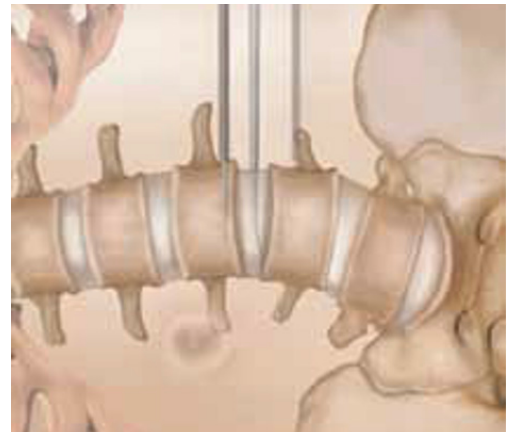

Figure 3



Figure 4

## DISTRACTING AND SIZING

- ▲ Select the appropriate sizer by footprint, height and lordotic angle, and attach it to the Straight or T Quick Connect Handle. Footprint, height, and lordotic angle measurements are clearly marked on the face of the sizers.
- ▲ Carefully impact the sizer into the disc space. Check the correct fit of the sizer with the aid of fluoroscopy and palpation.
- ▲ If the sizer is too loose or too tight, try the next larger/smaller size until a secure fit is achieved.
- ▲ Remove the sizer from the prepared disc space and select the corresponding implant.

NOTE: Although over distraction of the disc space is to be avoided, the largest implant that can be safely implanted in the disc space is generally the optimal implant size. Maximizing the implant surface with the vertebral endplates and providing an appropriate amount of preload through disc space distraction will help to create a stable environment conducive to new bone formation.

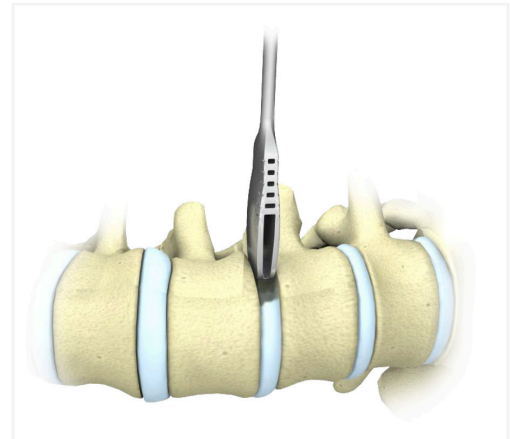

Figure 5

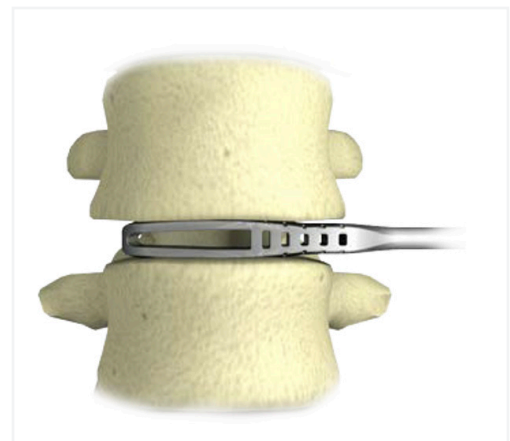

Figure 6



## IMPLANT PREPARATION

### Attaching Implant Inserter:

- ▲ LSTS Interbody Fusion Device implants are provided in a sterile package. Select the implant that corresponds to the appropriate sizer. Open the implant package using proper sterile technique.
- ▲ Attach the implant to the inserter. Ensure the prongs are fully seated and no threads are visible.
- ▲ Be careful not to over-tighten.

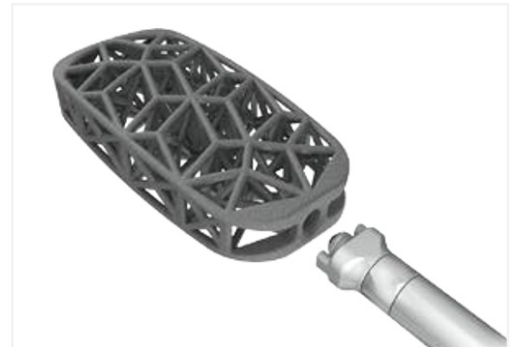

Figure 7

### Attaching LSTS-PS Integrated Plate:

- ▲ If an integrated plate is desired, the appropriate LSTS-PS Plate may be attached to the LSTS Interbody on the back table using the LSTS Plate Driver. After the LSTS Plate is attached to the LSTS Interbody, thread the LSTS Inserter into the LSTS Plate to insert the LSTS Plate and LSTS Interbody as one construct.



Figure 8

NOTE: The LSTS Integrated Plates have an internal fixation screw for locking the Plate to the Interbody. The LSTS Integrated Plate must be used with interbodies with 18° of lordosis or greater. If using a 1-hole Integrated Plate, additional supplemental fixation is required (e.g. posterior fixation). Please refer to the LSTS-PS Surgical Technique Manual for additional information, ST-LSTS-PS-01.



Figure 9

### Packing Implant:

- ▲ Pack the implant with autologous and/or allogenic bone graft. For best results, cut or morselize the autologous bone into 1–2mm sized particles. Place the morselized bone into the top or bottom web structure (top and bottom are interchangeable). In a downward, circular motion, massage the bone particles into the implant.
- ▲ Once packing has been completed through the top web structure, turn the implant over and repeat the placement of bone into the bottom web structure. Pack autologous and/or allogenic bone into the implant as appropriate.

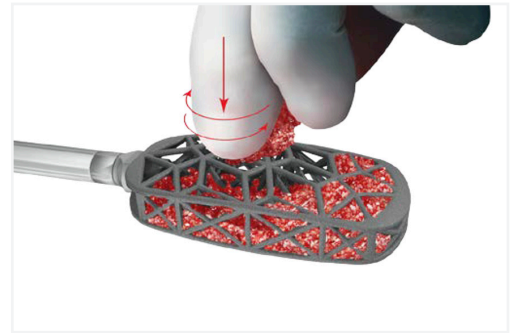

Figure 10

## IMPLANT INSERTION

### Insertion without Plate:

- ▲ Introduce the implant into the prepared intervertebral space and tap it into place with a mallet. Confirm the proper placement of the implant using fluoroscopy.
- ▲ Once the implant is in the proper position, disengage and remove the inserter.

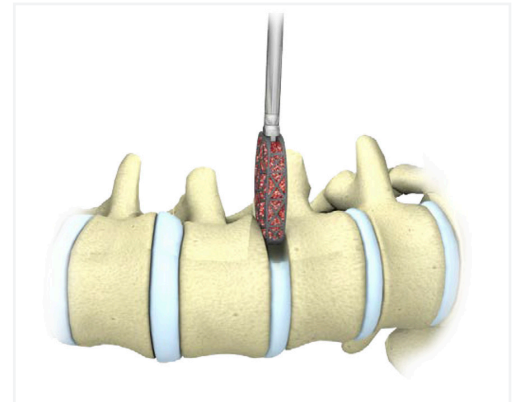

Figure 11

### Insertion with Plate:

- ▲ Once assembled, the LSTS Interbody/Plate construct should be inserted into the disc space. The LSTS Plate may also be assembled in situ using the In situ LSTS Plate Driver. Please refer to the LSTS-PS Surgical Technique Manual for information regarding screw hole preparation, ST-LSTS-PS-01.

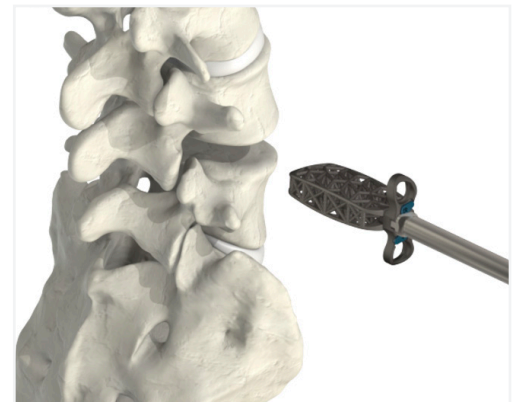

Figure 12

### **Distractor Shims:**

- ▲ Optional Distractor Shims are provided in the Implant Manipulation Tray. The Distractor Shims can be assembled on the Straight Inserter to aid in implant insertion. Confirm the proper placement of the implant using fluoroscopy.
- ▲ Once the implant is in the proper position, disengage and remove the inserter.

### **Implant Positioning:**

- ▲ If the implant needs to be positioned further into the prepared space, gently tap the implant with the tamp provided in the instrument tray.
- ▲ Verify final placement of the implant with fluoroscopic imaging.

## IMPLANT REMOVAL

- ▲ If implant removal is required, the intervertebral space should be distracted in the same manner as for implant placement. Once distracted, the implant may be removed by using the insertion tool.
- ▲ The implant should be disengaged from the superior and inferior endplates with the surgeon's preferred technique. The surgeon should apply slight back-pressure in order to remove the implant.
- ▲ If greater force is required, use the slap hammer provided in the Implant Manipulation Tray to remove the implant.



2801 NETWORK BLVD. SUITE 620

FRISCO, TX 75034

4WEBMEDICAL.COM

INFO@4WEBMEDICAL.COM

800.285.7090

ST-LSTS-01 | REV F